



GIRL GUIDES
AUSTRALIA
VICTORIA

Snoozerella 2018



UNDERWATER MAGIC

Friday 13 July to Saturday 14 July 2018

Melbourne Sports and Aquatic Centre,

30 Aughtie Dr, Albert Park 3206

Snoozerella Underwater Magic is a sleepover at Melbourne Sports and Aquatic Centre for Guides aged 5 to 9 years. Guides do not need to attend with their Unit or Unit Leader. The activities provide Guides with the opportunity to challenge themselves, have lots of fun, and meet other Guides from across the State. Through a program based on the Underwater Magic theme, Guides will develop their confidence, make new friends, and create lasting memories.

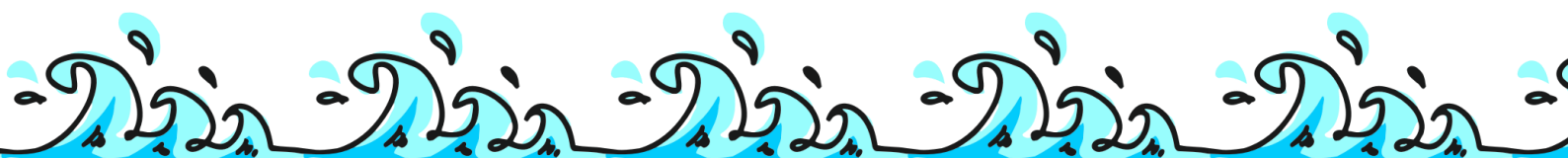

When

Start time: 5.00 pm Friday 13 July

Finish time: 8.00 am Saturday 14 July

Where

Melbourne Sports and Aquatic Centre (MSAC), 30 Aughtie Drive, Albert Park

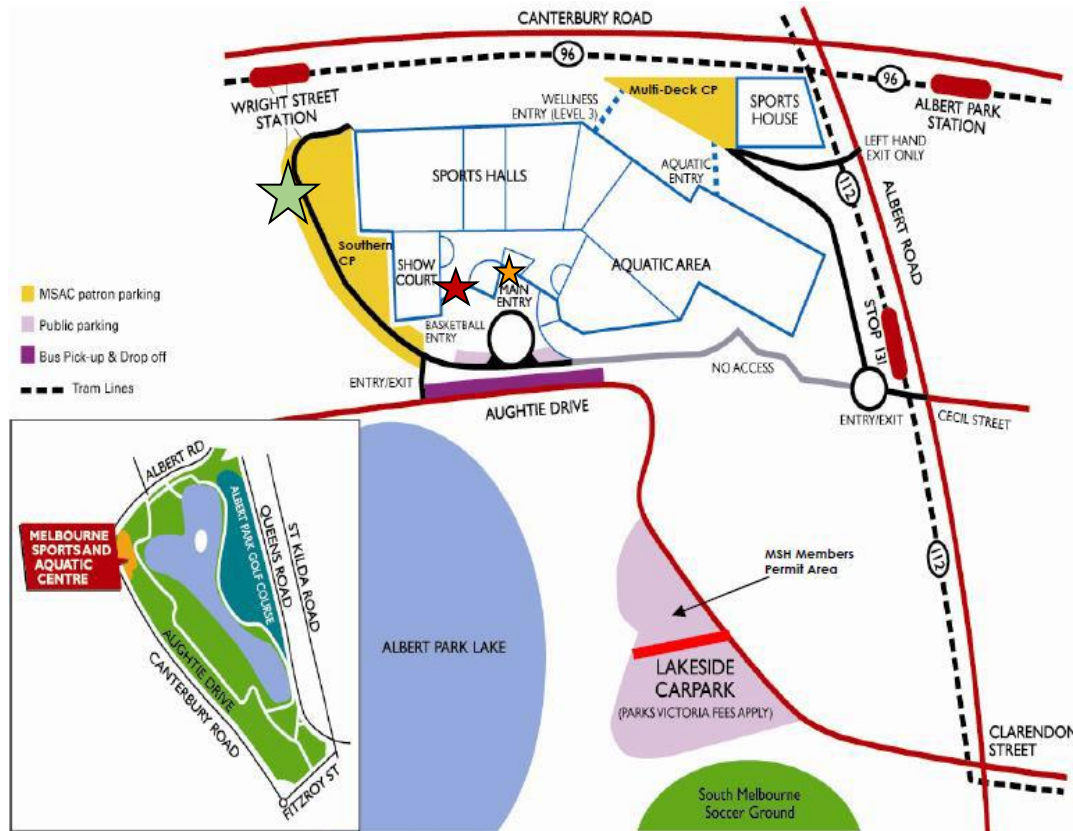

★ Entry to MSAC here

☆ Park Here

★ Sign-in here

Program

Each Guide will also have the opportunity to explore her *creative self* with a dress up photo booth and a number of craft activities related to the theme; and her *adventurous self* by swimming in the pool; and her *social self* with lots of new friends!

Friday

5.00 pm - 5.30 pm: Sign-in

5.45 pm: Dinner

6.30 pm - 9.30 pm: Activities

10.30 pm: Lights out!

Saturday

6.15 am: Wake up

7.00 am: Pack up

7.30 am: Breakfast

8.00 am - 8.30 am: Sign-out

Guides will be sleeping inside on the floor of the basketball courts. There will be Guide leaders supervising the Guides at all times.

Cost: \$90.00

This includes:

- Entrance to the venue
- Dinner, supper and breakfast
- Creative activities, games, and crafts
- Administrative costs

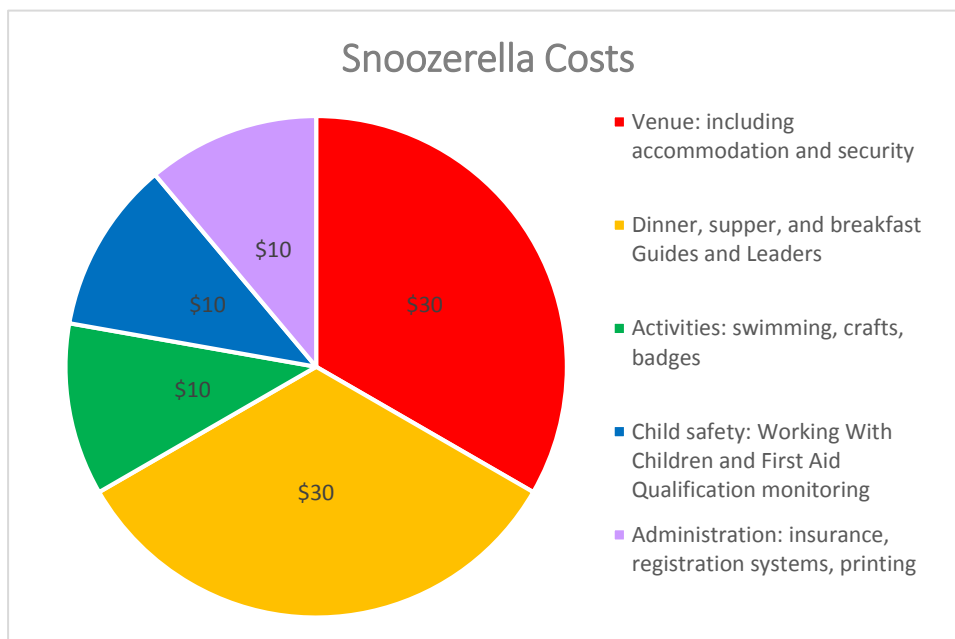

Snoozarella will be staffed by, volunteers. In light of this, parents and guardians often ask how event fees are used. As a membership association, GGV is happy to share this information. For this event, a large portion of the cost is for MSAC (entry fees, food, lighting, security, etc.). The rest of the fees support registration processes, health and First Aid planning, program materials, qualification and compliance monitoring for volunteers, and organising team expense reimbursement.

All program activities at Snoozarella are covered by the registration fee. No other spending money is needed for the event.

Registration details

Youth event registration and payment will be via the Girl Guides Victoria website.

Registrations will close at midnight on 18 June 2018, or sooner if the event reaches capacity. We highly recommend early registration, as historically this event reaches capacity early.

Leader Expressions of Interest will be collected via an online form. These must be submitted by 5.00 pm **on 25 June 2018**. Please note that Leaders will be selected based on the skills required for this event, and on the location of the Guides who register. It may be the case that not all adults who express interest will be able to attend.

This is a large event and the volunteer team will be very busy after registration closes - grouping Guides, registering Leaders and checking qualifications, planning for special needs, and adjusting the program. Therefore, we cannot accommodate late registrations.

Getting there

Driving: MSAC very accessible by car. There is plenty of parking, but some areas are metered. It is recommended that you use the parking at the Stadium.

Public transport: There are a number of tram routes that service MSAC. The 96 (Light Rail) stops along Clarendon Street and the 12 stops on Albert Street. Both stops are walking distance from MSAC.

Sign-in on the day

Guides will gather in assigned groups near the Main Entrance of MSAC. Groups will be assigned once registration has closed. Groups will be made up of closely located Units or girls from the same District where possible.

Once the full group has arrived, Guides will proceed to sign in together. Each Guide will need to be **holding her own health form** (see below), and any medication.

Health and First Aid

There will be a qualified volunteer First Aider at all times in a dedicated First Aid Area.

Girl Guides Victoria (GGV) relies on the information from a Guide's profile on our database regarding medical and developmental support needs to plan staff ratios at events. Please ensure this profile is up-to-date. This will be prompted on registration.

Because we know that health changes, approximately a week prior to the event a 'health form' will be emailed to all participants. Parents will be able to review health details and make any changes as necessary. This will then need to be printed and brought to Snoozerella.

For safety reasons, **Guides will not be permitted entry without a health form and a copy of any health/medical management or support plan if required.** The First Aid team will review profiles and phone parents to discuss health or developmental needs in the week prior to the event if required. GGV will make every possible effort to accommodate a Guide's health or support needs if disclosed and discussed with the event team prior to the event.

In line with our duty of care obligation, if a Guide arrives with a support requirement about which the volunteer staff have not been notified, or for which the volunteer staff cannot cater (for reasons of supervision ratio or training), it is very likely the Guide will not be able to join the event. Please provide all information required upon online registration.

GGV understands that sometimes a quiet and calm space is needed at big events, and are providing an area for retreat if a Guide reaches their sensory or activity threshold.

All personal **medication** must be:

- Handed in upon sign-in (this includes analgesics such as paracetamol and ibuprofen)
- In its original packaging in a snap-lock bag clearly labelled with: Guide's full name
- With dosage instructions itemised on the 'Health Form'

Medications will be available for collection from First Aider from 8.00 am on Saturday.

Please note that GGV volunteers are not permitted to issue any medication to participants without the consent of their guardian.

Accommodation

Our accommodation this year will be Show Courts 1 & 2, which are Basketball Courts. We have a large area of two basketball courts wide. The area is enclosed and there will be no public access to the sleeping areas.

Girls will be sleeping in their groups. Leaders assigned to these groups will be sleeping nearby.

The Leaders will have designated sleeping areas. They will not be permitted to sleep right next to their girls.

Technology – electronic devices and mobile phones

Girl Guide events are great opportunities to spend time with friends, get to know others, and enjoy all the amazing experiences on offer. For this age group, which is under the 13-year-old threshold for most social media platforms, Girl Guide Leaders cannot effectively monitor photo permissions and safe media usage, and therefore Girl Guides requests that all devices are left at home.

If you need to contact your Guide during the event for emergency reasons, please call the event Leader in Charge Heather Hyatt on 0412 230 594. Parents and guardians are asked to otherwise refrain from contacting Guides during the event as it is disruptive and may cause homesickness in younger Guides.

Conditions of attendance

All participants must be current members of Girl Guides Victoria and be registered.

All participants are expected be at the event from 5.00 pm Friday until 8.00 am Saturday.

To maintain security, we can only accommodate late arrivals or early departures in exceptional circumstances, which must be arranged at least 2 weeks in advance.

Volunteer Leaders will work with Guides to set clear rules for the night, including the MSAC rules. If Guides are having trouble abiding by the agreed rules, or are disrupting the experience for others, parents or guardians will be asked to come collect Guides at their own cost.

Supervision

Water Supervision: We are required by MSAC to have at 10 Leaders in the water at all times. We will more than meet this requirement. We will also have additional Leaders standing around the pool during their group's 'water' time to ensure maximum safety.

Please note that MSAC qualified lifeguards will also be supervising at all times.

Kit List

Guides will wear Guide polo and/or Guide jumper for this event.

All Guides need to wear their swimmers/bathers underneath their uniform.

PLEASE ENSURE EVERYTHING IS CLEARLY NAMED, especially uniform tops!

Please pack with your Guide so she knows where everything is, and remember that Guides have to carry their own gear. Guides this age can usually manage a backpack, a sleeping bag, and a mat; OR a backpack and a bag of sleeping gear.

Please see below for a list of items Guides need to bring.

Required	Description or notes
Bedding (in a bedroll, in a bag together, or Guides able to carry all the pieces):	
Sleeping mat	Foam or self-inflatable mat - NO lilos or stretchers
Sleeping bag	Quality, temperature rated sleeping bag
Pillow case or small pillow	A jumper or other clothing can be used as a pillow inside the pillow case
Blanket	(optional)
Inner sheet	(optional)
Small backpack containing:	
Health Form	Will be emailed after registration; must be current <i>on the day of the event</i>
Any medication	In a snap lock bag, labelled with full name and dosage
Drink bottle	Minimum 600 mL
Toiletries - toothbrush and toothpaste - hairbrush and hair ties	In a snap lock bag or toiletries bag Remember pull-ups and/or sanitary pads if required
2 x Plastic Bags	1 for wet bathers; the other as just in case!
Pyjamas	Warm - for sleeping in
Towel	Very important!
Spare clothes - underwear - socks - warm jumper (if not wearing one to the venue) - Bathers/swimmers - Towel - Small torch	Girls don't need a full change of clothes because they will sleep in their pyjamas and then put their uniform on to go home.
Camera	Optional; named
Small toy/Teddy	Optional, for bedtime only; named